

DIRECTORY

ART & DESIGN EAST

Send Comments on Floor Plan to:
donande@siue.edu

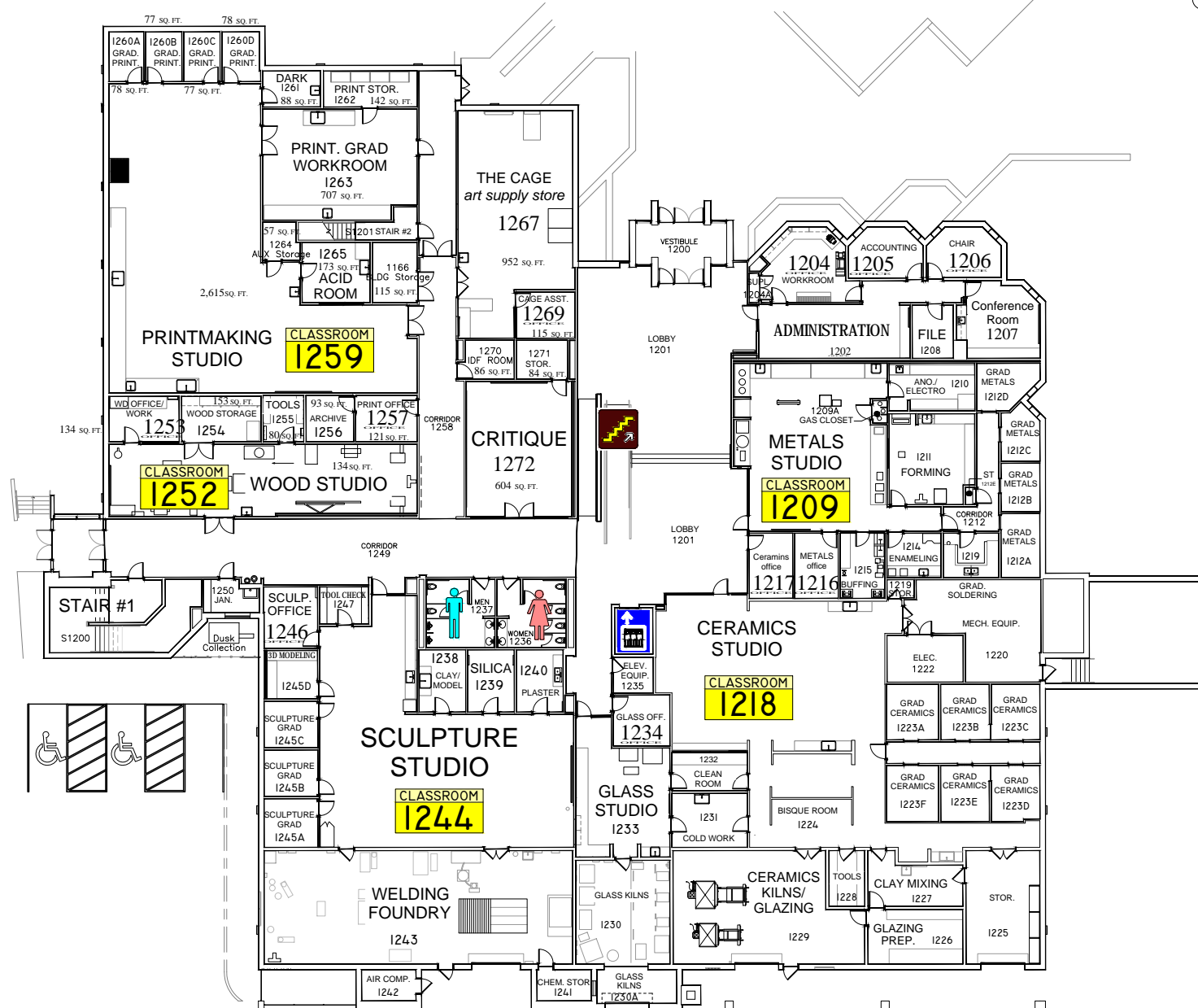

1st FLOOR

- 1202 Administration
- 1267 The Cage
- 1272 1st Floor Critique
- 1218 Ceramics Studio
- 1109 Metals Studio
- 1159 Printmaking Studio
- 1244 Sculpture Studio
- 1252 Wood Studio

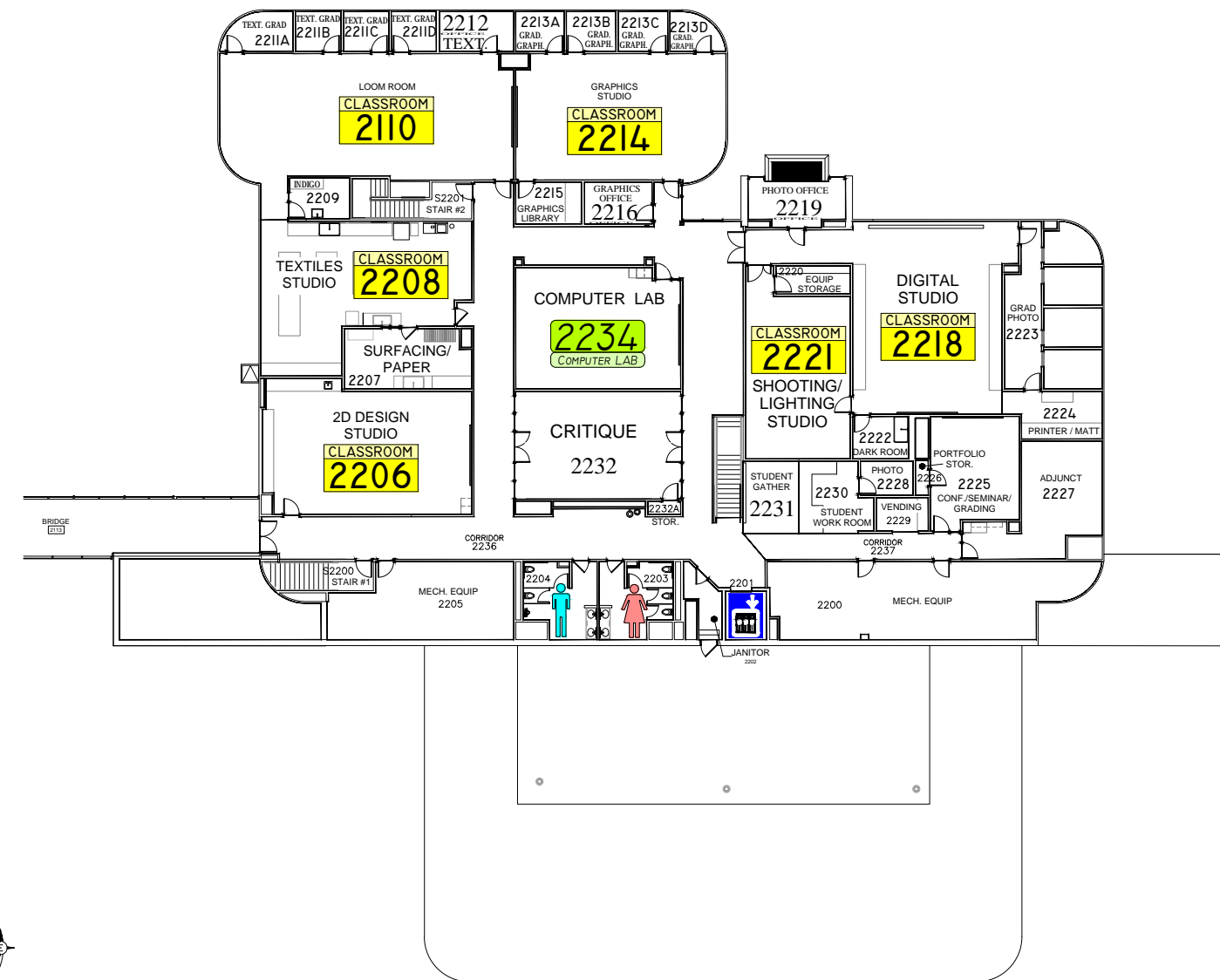

2nd FLOOR

- 2234 Conference/Seminar/Grading Room
- 2234 Computer Lab
- 2232 2nd Floor Critique
- 2102 2D Design Studio
- 2108 Graphics Studio
- 2103 Digital Studio
- 2105 - Shooting/Lighting Studio
- 2106 Textiles Studio
- 2101 - Loom Room

ART & DESIGN East

Send Comments on Floor Plan to:

donande@siue.edu

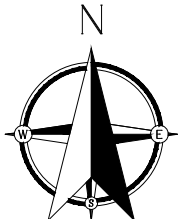
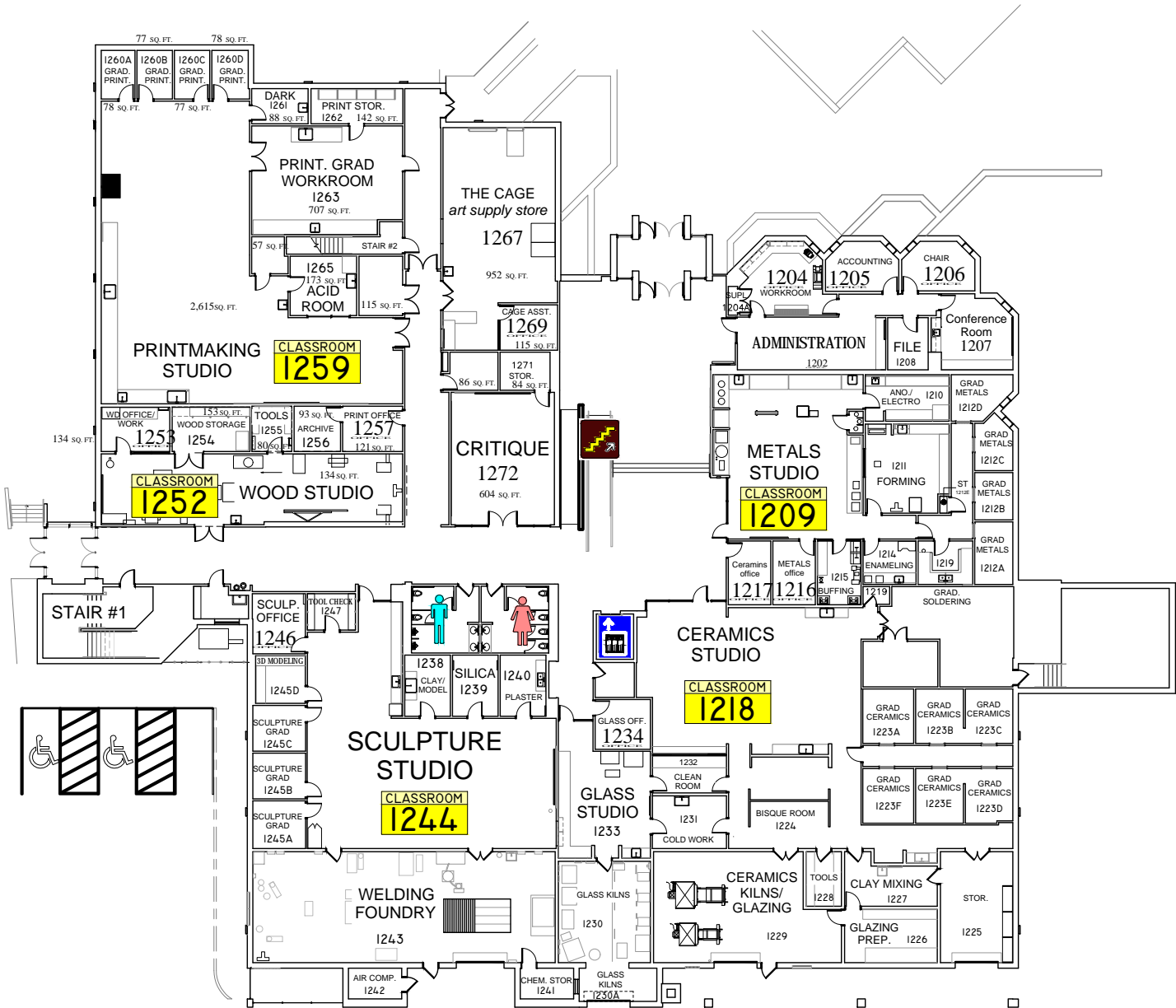

1st FLOOR

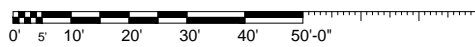

ART & DESIGN East

Send Comments on Floor Plan to:

donande@siue.edu

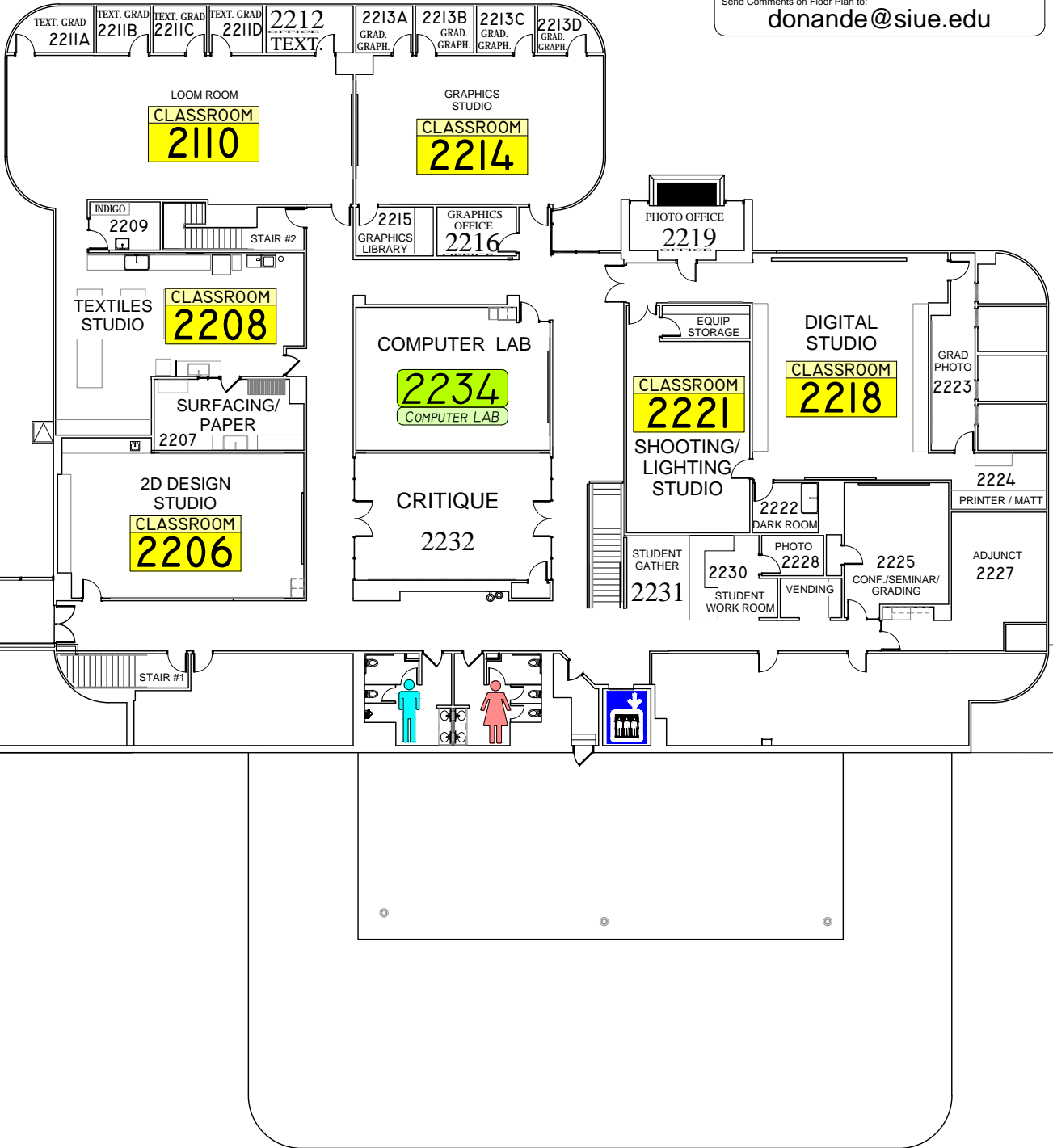

2nd FLOOR

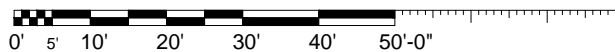

EMERGENCY STORM SHELTERS

In event of a Tornado Warning everyone should go to a Lower Level **Primary Storm Shelter**

In event you can not get to a Primary Shelter go to a **Secondary Storm Shelter**

located on 1st and 2nd floors

ART & DESIGN BUILDING

1st FLOOR

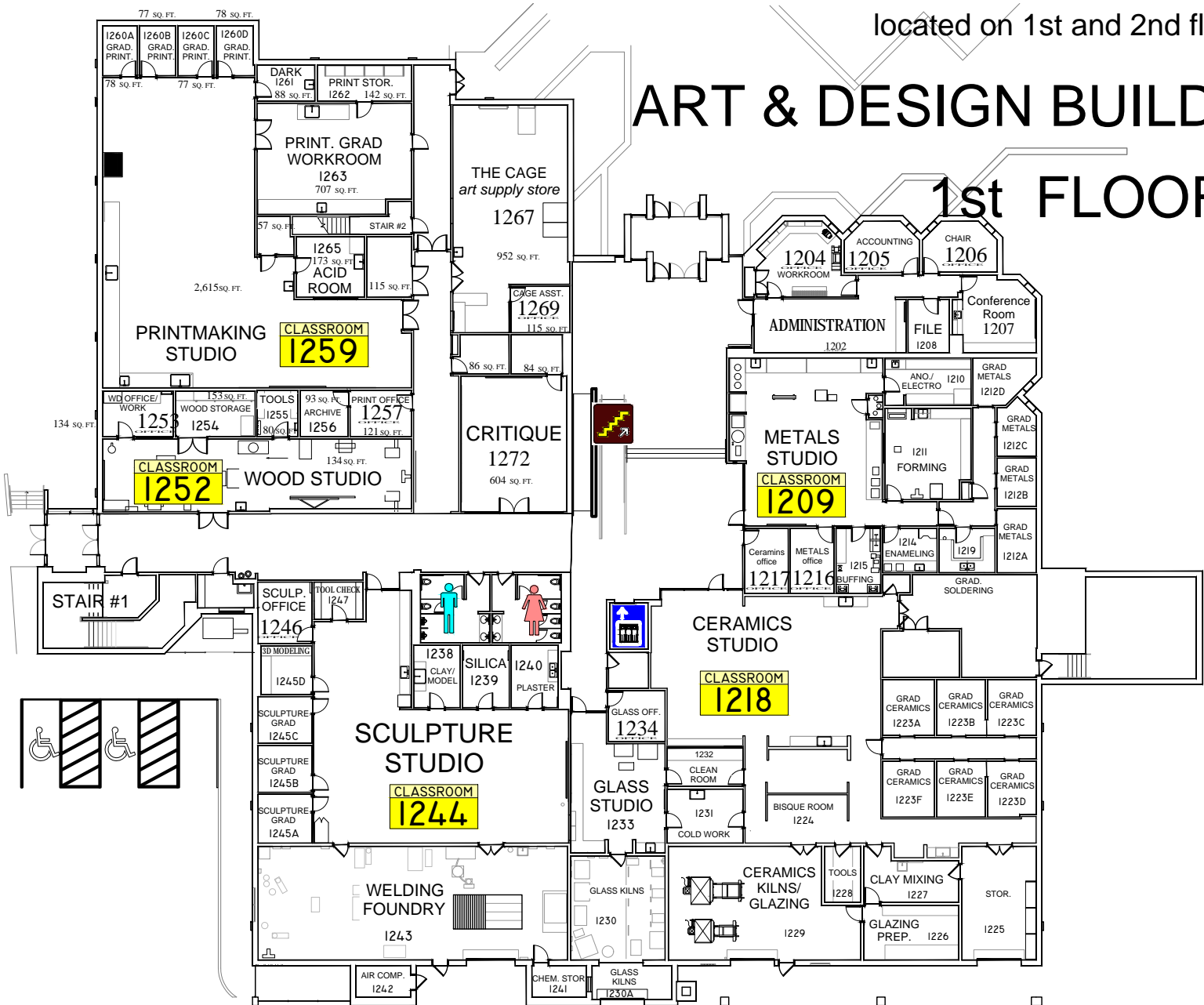

EMERGENCY STORM SHELTERS

In event of a Tornado Warning everyone should go to a Lower Level **Primary Storm Shelter**

In event you can not get to a Primary Shelter go to a **Secondary Storm Shelter**

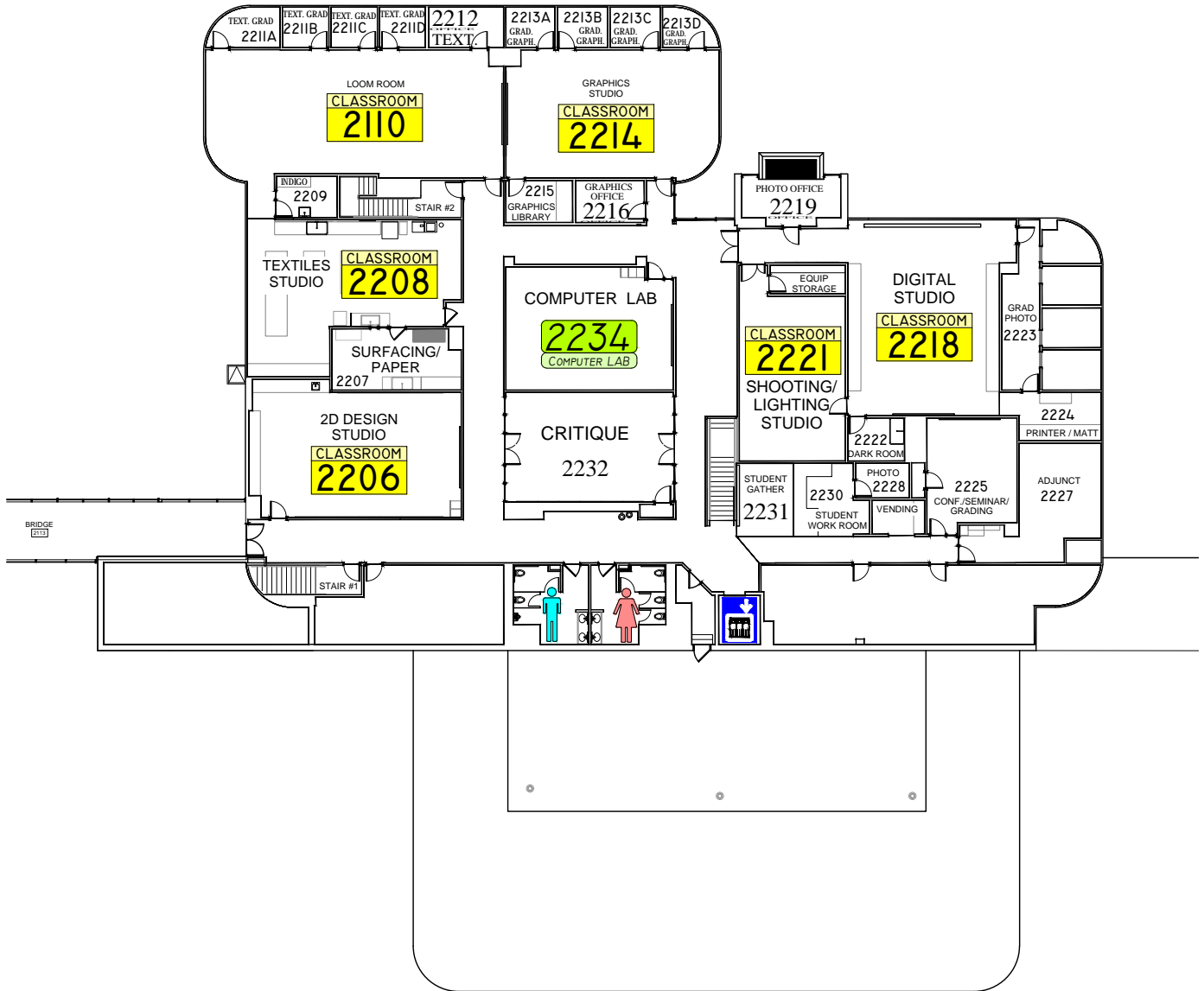

ART & DESIGN BUILDING 2nd FLOOR

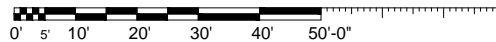

EMERGENCY EXIT PLAN

EXIT

IN CASE OF EMERGENCY USE MARKED EXITS

EXIT



DO NOT USE ELEVATORS

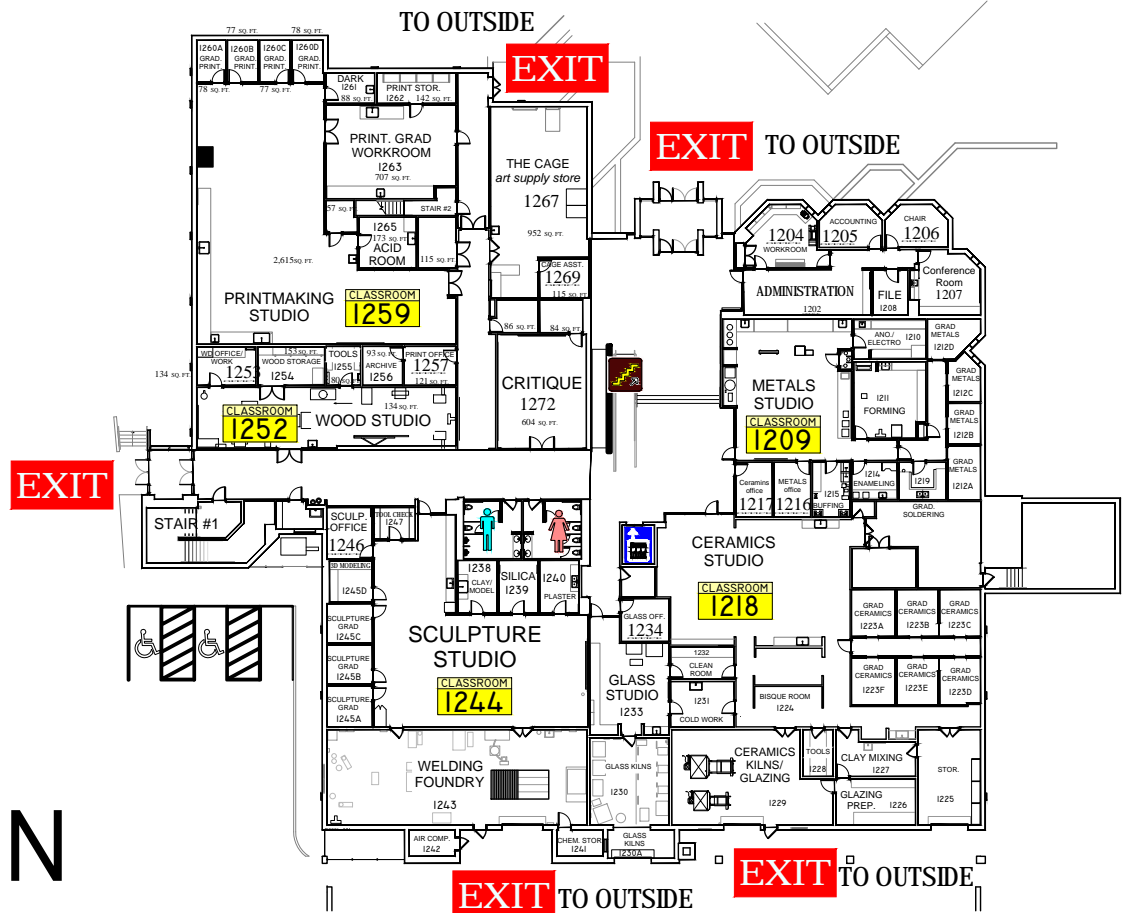

ART & DESIGN
1st FLOOR

1st FLOOR

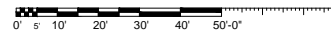

EMERGENCY EXIT PLAN

EXIT IN CASE OF EMERGENCY USE MARKED EXITS **EXIT**

 DO NOT USE ELEVATORS 



WHEELCHAIR USERS ARE TO GO INTO



STAIR WELLS **EXIT** AND WAIT FOR EMERGENCY PERSONNEL.

